



AG 626

Configurable multi-turn absolute angle encoder



The advantages in brief

24 Bit, multi-turn absolute angle encoder
(no battery back-up)

 and RS 422 configurable interface

Electronically adjustable
configurable resolution

Compact dimensions

Highly shock- and vibration-proof

High degree of protection IP 65

Basic resolution
max. 8192 steps, 8192 revolutions

Accessories:

Cable 12-core (flexible)
The **C 12 FUR** mating connector
(socket part) is not included
in the items supplied.
Please order separately.

Connector assignments

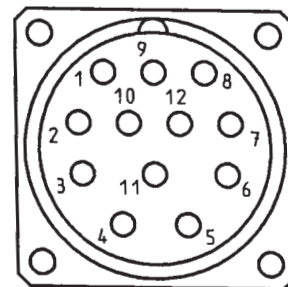

Pinout

Pin	Colour	Signal
1	blue	GND
2	white	Data +
3	yellow	Clock +
4	grey	R x D +
5	green	R x D -
6	pink	T x D +
7	black	T x D -
8	red	US
9	orange	SET
10	brown	Data -
11	lilac	Clock -
12	orange / black	CW/CCW

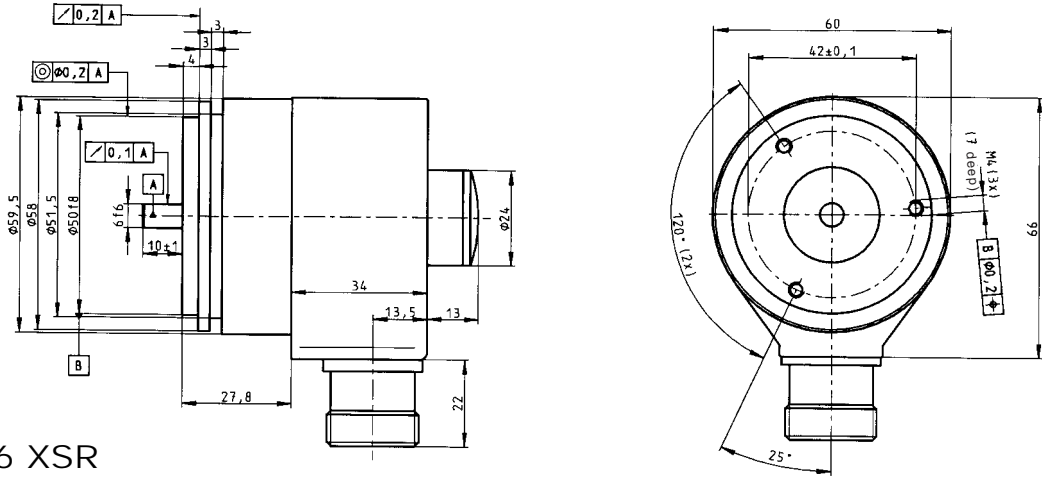

AG 626 XSR

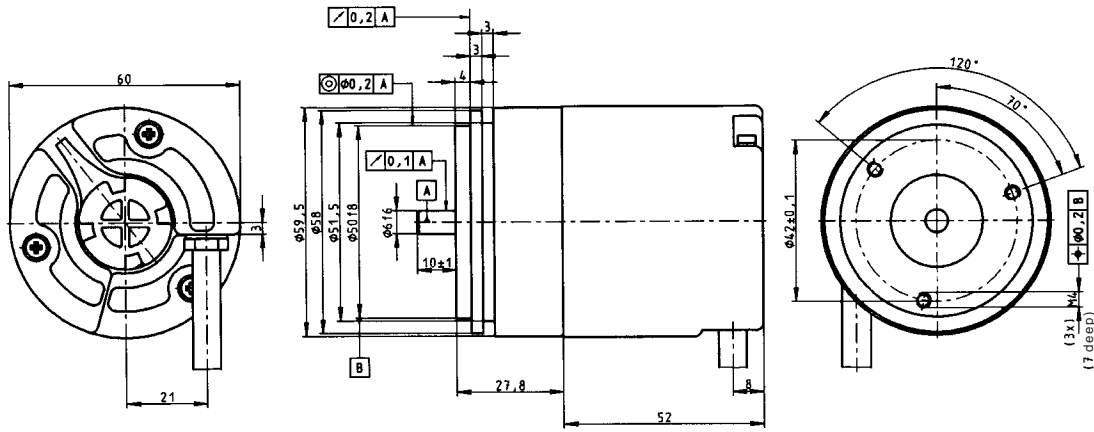

AG 626 XKR - cable length 1.5 m, cable diameter 8 mm

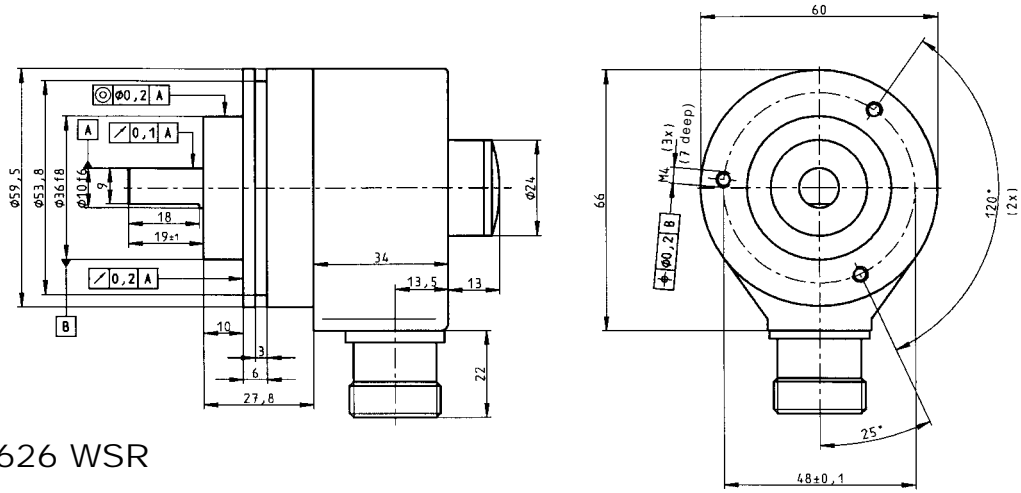

AG 626 WSR

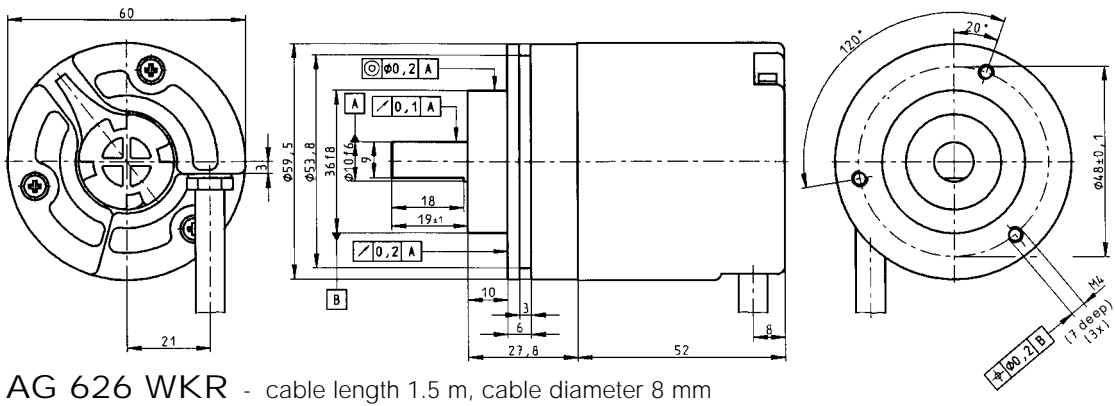

AG 626 WKR - cable length 1.5 m, cable diameter 8 mm

AG 626



Technical Data and characteristics according to DIN 32878

		Units
Dimensions	see drawing	mm
Mass	0.5	kg
Moment of inertia of the rotor	35	gcm ²
Programmable code type	Gray/Binary	
Programmable code direction	cw/ccw	
Measuring step	2.6	minutes of arc
Max. number of steps per revolution	8192	
Max. number of revolutions	8192	
Error limits	40	minutes of arc
Repeatability	0.1	degrees
Working speed	6000	min ⁻¹
Operating speed	12000	min ⁻¹
Position forming time	0.5	ms
Max. angular acceleration	5x10 ⁵	rad/s ²
Operational torque with shaft sealing ring	1.8	Ncm
Operational torque without shaft sealing ring	0.3	Ncm
Start-up torque with shaft sealing ring	2.5	Ncm
Start-up torque without shaft sealing ring	0.5	Ncm
Max. shaft loading, axial	50	N
Max. shaft loading, radial	300	N
Bearing lifetime	3.6 x 10 ⁹	revolutions
Working temperature range	- 20... + 85	° Celsius
Operating temperature range	- 40... + 100	° Celsius
Storage temperature range	- 40... +125	° Celsius
Permissible relative humidity	98	%
Condensation permissible (on request)		
EMC according		
IEC 1000-4-2 (IEC 801-2) Electrostatic discharge	1 (2)	level (KV)
IEC 1000-4-4 (IEC 801-4) Burst	3 (2)	level (KV)
Resistance to shocks in the mounted state according to DIN IEC 68 Part 2-27	100/6	g/ms
Resistance to vibration in the mounted state according to DIN IEC 68 part 2-6	20/10 . . .2000	g/Hz
Degree of protection acc. to DIN VDE 0470 Part 1 with shaft sealing ring	IP 65	
without shaft sealing ring on encoder flange sealed	IP 66	
without shaft sealing ring on encoder flange not sealed	IP 43	
Operating voltage range	10 ... 32	V
Recommended supply voltage	15	V
Max. operating current without load	150	mA
Initialisation Time:	1050	ms
From the moment the supply voltage is applied, this is the time which elapses before the data word can be correctly read in.		
Signal line via 12-pin connector, potential-free w. r. t. housing		
Interface signals		
Clock +, Clock -, Data +, Data - ;	SSI	
TxD +, TxD -, RxD +, RxD -	RS 422	
SET (electronic adjustment)	"H" - active (L _Δ 0 - 4.7V; H _Δ 10-24 V)	
CW/ CCW (step sequence in direction of rotation)	"L" - active (L _Δ 0 - 0.9 V; H _Δ 1 .9 - 24 V)	